

## Other Plants

### Trees

Virginia Pine (*Pinus virginiana*) ★ ↑

White Oak (*Quercus alba*) ★ ↑

Northern Red Oak (*Quercus rubra*) ★ ↑

Willow Oak (*Quercus phellos*) ★ ♡ ↑

Red Maple (*Acer rubrum*) ★ ♡ ↑

American Holly (*Ilex opaca*) ★ ↑

Common Serviceberry (*Amelanchier arborea*) ★

Flowering Dogwood (*Cornus florida*)

Eastern Redbud (*Cercis canadensis*)

River Birch (*Betula nigra*) ♡ ↑



Flowering Dogwood

### Vines

Carolina Jasmine (*Parthenocissus quinquefolia*) ★

Coral Honeysuckle (*Lonicera sempervirens*) ★

Purple Passionflower (*Passiflora incarnata*) ★

Red Morning Glory (*Ipomoea coccinea*) ★ ↔

Crossvine (*Bignonia capreolata*) ★

American Trumpet Vine (*Campsis radicans*) ★ ↑

\*\*\*Avoid planting American Trumpet Vine on dwellings or small trees. Its size can damage structures and weaker trees!\*\*\*

## Landscaping Tips

It is hard to say how you should plant your landscaping, but here are a couple tips. Some people like the “messy meadow” look, but others like more of a neat and tidy appearance. To maximize plant viewing, you want to put your largest plants in the background and the smallest plants in the foreground.

Here are two simple ways to do this.

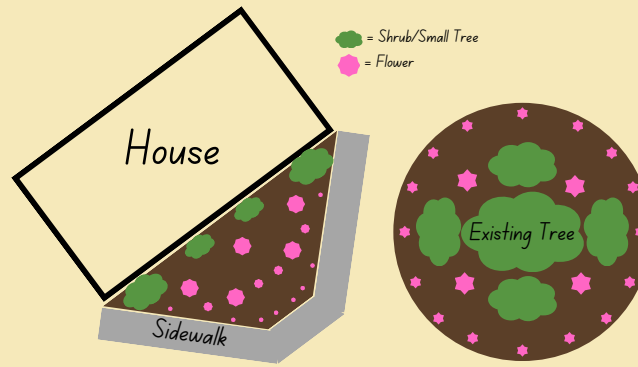

Note in the circular example, the center is your “background” or focal point. On the left example, using larger shrubs or small trees on the back corners, forces the perspective to make one feel they are in a small piece of something larger. These little tricks can make your landscape feel like a real slice of nature.



Wild Columbine

# Native Plants for Landscaping

## Prince Edward and Surrounding Counties



American Beautyberry

## A Guide to Native Plants that can be Sourced Easily in our Region

Compiled by Ty Smith --  
Conservation Technician with  
Piedmont Soil and Water  
Conservation District  
PiedmontSWCD.org

# How to Use This Guide



Carolina Jasmine

This guide is to help you get started with some common, native plants that you may find at a local nursery or with the Virginia Department of Forestry. Keep in mind you need to pick the right plant for the conditions (and for the job you want it to provide). These plants are categorized with the following symbols:

☀ Dry Conditions

💧 Wet Conditions

↔ May Spread Aggressively

↑ Grows Large

Plants that “spread aggressively” will help stabilize and cover a slope, but may not be what you want in your flower bed if you want it to be neat and tidy. Some plants grow larger than others in their groups, like Black Elderberry (which is a shrub that can grow 20' tall). For more information on native plants and range maps, visit [vnps.org/virginia-native-plant-guides](http://vnps.org/virginia-native-plant-guides)

# Full Sun

## Perennials

Clustered Mountainmint (*Pycnanthemum muticum*) ☀ ↔

Black-eyed Susan (*Rudbeckia hirta*) ☀

Scarlet Beebalm (*Monarda didyma*)

Swamp Rose Mallow (*Hibiscus moscheutos*) ☀ ↑

Moss Phlox (*Phlox subulata*) ☀ ↔

Butterfly Milkweed (*Asclepias tuberosa*) ☀

Swamp Milkweed (*Asclepias incarnata*) ☀ 💧

Northern Blue Flag Iris (*Iris versicolor*) ☀ ↔

Tall Blue Wild Indigo (*Baptisia australis*) ↔

Dense Blazing Star [Gayfeather] (*Liatris spicata*)

Common Yucca (*Yucca filamentosa*) ☀

Joe-Pye Weed (*Eutrochium dubium*) ☀ ↑

Blanketflower (*Gaillardia pulchella*)

Whorled Coreopsis (*Coreopsis verticillata*)

Lobed Coreopsis (*Coreopsis auriculata*)

## Shrubs

American Beautyberry (*Callicarpa americana*) ☀

Button Bush (*Cephalanthus occidentalis*) 💧

Red Chokeberry (*Aronia arbutifolia*) ☀

Virginia Sweetspire (*Itea virginica*) 💧

Black Elderberry (*Sambucus canadensis*) ☀ ↑

New Jersey Tea (*Ceanothus americanus*) ☀

Yaupon Holly (*Ilex vomitoria*) ☀

## Grasses

Pennsylvania Sedge (*Carex pensylvanica*) ☀ 💧

Little Blue Stem (*Schizachyrium scoparium*) ☀

Big Bluestem (*Andropogon gerardi*) ☀

Indiangrass (*Sorghastrum nutans*) ☀

Switchgrass (*Panicum virgatum*) ☀ ↔

# Shade/Part-Shade

\*\*\*Many (not all) of these “shade plants” do fine in part or full sun as well.\*\*\*

## Perennials

Virginia Bluebells (*Mertensia virginica*) 💧

Common Blue Violet (*Viola sororia*) 💧

American Alumroot (*Heuchera americana*)

Wild Columbine (*Aquilegia canadensis*) ☀

Canadian Wild Ginger (*Asarum canadense*)

Woodland Phlox (*Phlox divaricata*)

## Ferns

Christmas Fern (*Polystichum acrostichoides*)

Northern Maidenhair Fern (*Adiantum pedatum*)

Cinnamon Fern (*Osmunda cinnamomra*) 💧

## Shrubs

Winterberry Holly (*Ilex verticillata*) 💧

Northern Spicebush (*Lindera benzoin*) 💧

Common Witch-Hazel (*Hamamelis virginiana*) ☀

Black Chokeberry (*Aronia melanocarpa*) ☀

Great Rhododendron (*Rhododendron maximum*)

## Grasses

River Oats (*Chasmanthium latifolium*) ↔

Bottlebrush Grass (*Elymus hystrix*) ☀

Virginia Wildrye (*Elymus virginicus*) ☀



Clustered Mountainmint